

General Notes:

- 1) Indicate location of all buildings on the Property, including sizes.
- 2) Plans submitted for review are to be drawn to a recognized scale. (ie 1" = 20'-0")
- 3) Do not submit this Sample Site Plan as part of your Drawing Package.
- 4) Where a Roofed Enclosure used for the storage or parking of Motor Vehicles has more than 60% of total perimeter Enclosed by Walls, Doors or Windows, the Enclosure shall be considered a Garage.
9.35.2.1 (O.B.C.)
- 5) **Carport** (Zoning By-Law 2010- 100Z definition)
An accessory private garage, either attached or detached from the main building, which is partially enclosed with a roof but open at each end and on at least on side, except for any necessary structural roof supports.

Setback Requirements:

- 1) Interior Side yard, with the side facing the same lot line having No Walls. No closer than 2'-0" (0.6m) from Interior Side lot line.
- 2) Interior Side yard with the side facing the same lot line having a wall. No closer than 4'-0" (1.2m) from Interior Side lot line.
- 3) Measurement for Setback taken from Outside Face of Column &/or Supporting Wall or Roof Overhang. (whichever is closest)

NOTE:

It is the Contractor's responsibility to ensure that all construction conforms to the requirements of the Ontario Building Code. Notations made on these drawings are for your information and assistance only and do not necessarily comment on all areas of construction.



Attached Carport

Site Plan (not to scale)

DRAWN BY: E.P.

DATE: 14/02/23

CP-1
SHEET

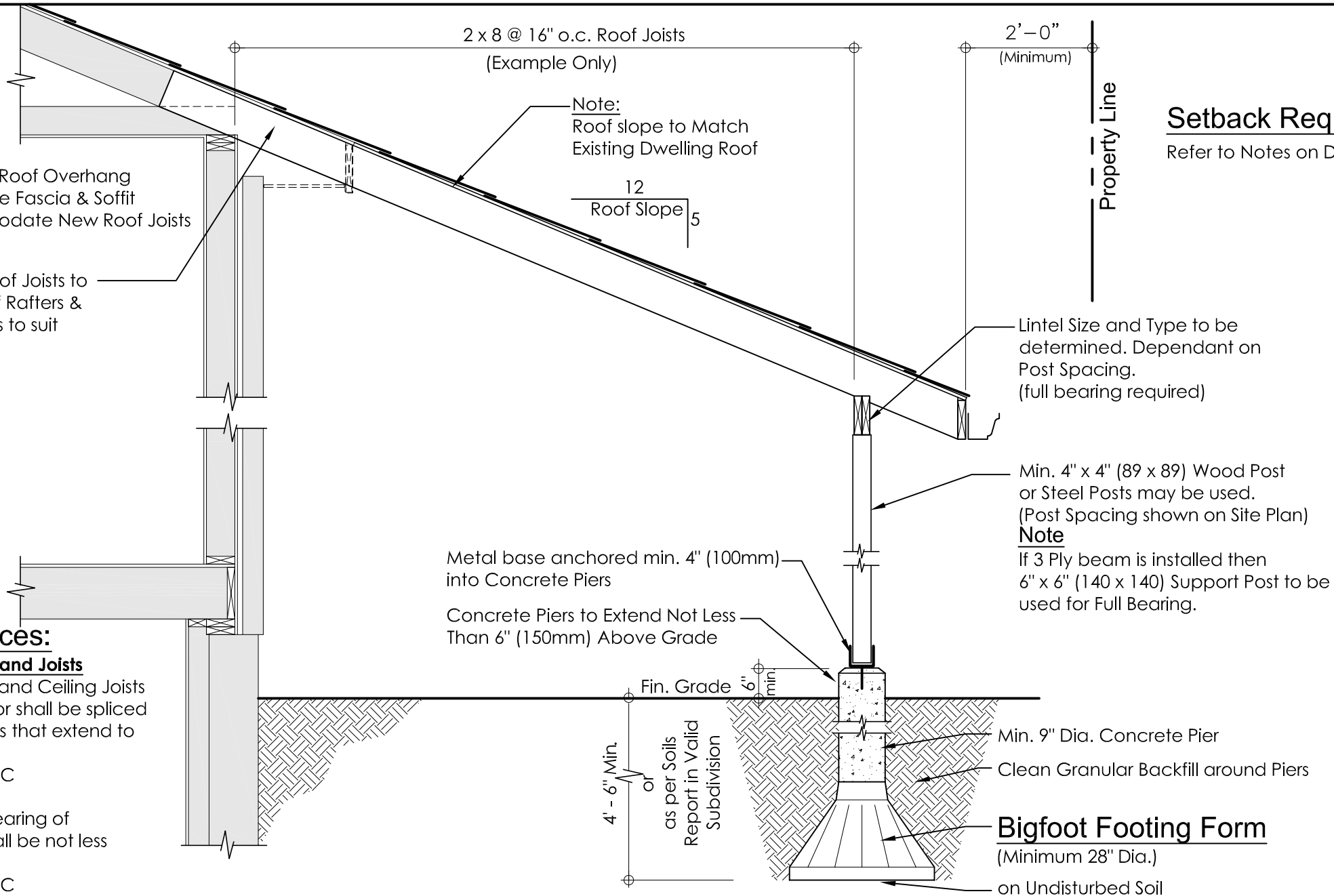

Setback Requirements:

Refer to Notes on Drawing **CP-1**

Cut Existing Roof Overhang &/or Remove Fascia & Soffit to accommodate New Roof Joists as required

Nail New Roof Joists to Existing Roof Rafters & Ceiling Joists to suit as per OBC.

Note:
Roof slope to Match Existing Dwelling Roof

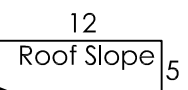

Lintel Size and Type to be determined. Dependant on Post Spacing. (full bearing required)

Min. 4" x 4" (89 x 89) Wood Post or Steel Posts may be used. (Post Spacing shown on Site Plan) **Note**

If 3 Ply beam is installed then 6" x 6" (140 x 140) Support Post to be used for Full Bearing.

Metal base anchored min. 4" (100mm) into Concrete Piers

Concrete Piers to Extend Not Less Than 6" (150mm) Above Grade

4' - 6" Min. or as per Soils Report in Valid Subdivision

Min. 9" Dia. Concrete Pier

Clean Granular Backfill around Piers

Bigfoot Footing Form
(Minimum 28" Dia.)

on Undisturbed Soil

Code References:

1) Continuity of Rafters and Joists

Roof Rafters & Joists and Ceiling Joists shall be continuous or shall be spliced over vertical supports that extend to suitable bearing.

9.23.13.1.(1) OBC

2) End Bearing Length

The Length of End Bearing of Joists and Rafters shall be not less than 1 1/2" (38mm)

9.23.13.3.(1) OBC

NOTE:

It is the Contractor's responsibility to ensure that all construction conforms to the requirements of the Ontario Building Code. Notations made on these drawings are for your information and assistance only and do not necessarily comment on all areas of construction.



Attached Carport

Attached to Existing Dwelling Roof

Cross Section

(not to scale)

DRAWN BY: E.P.

DATE: 14/02/23

CP-2
SHEET

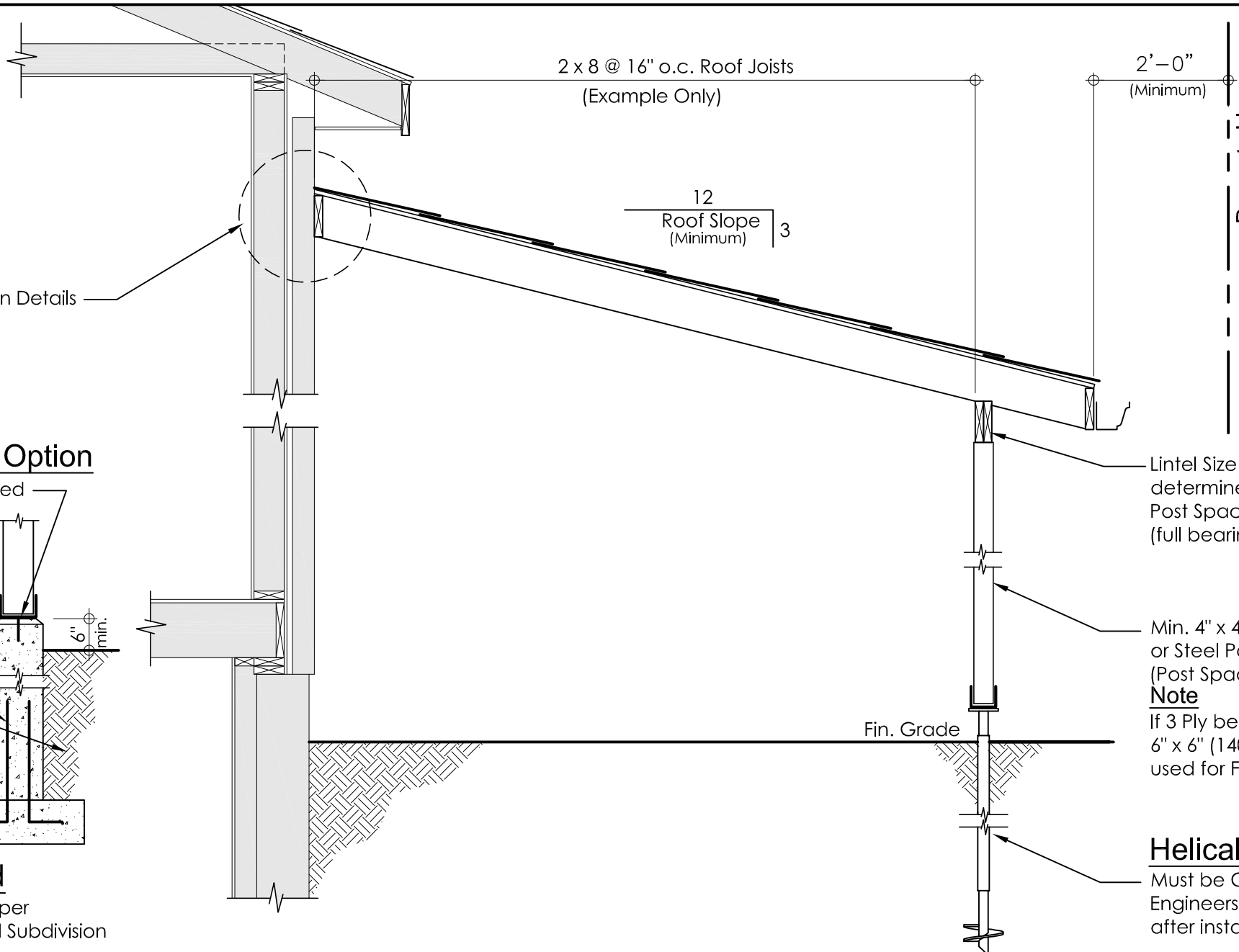

Setback Requirements:
Refer to Notes on Drawing **CP-1**

Post Support Option

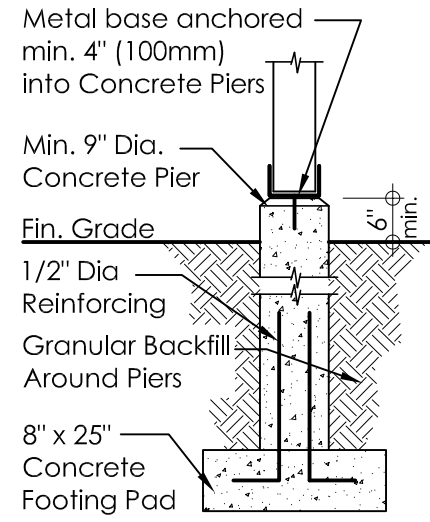

Concrete Pad
Frost Depth 4'-6" or per Soils Report in Valid Subdivision

NOTE:
It is the Contractor's responsibility to ensure that all construction conforms to the requirements of the Ontario Building Code. Notations made on these drawings are for your information and assistance only and do not necessarily comment on all areas of construction.



Attached Carport
Attached to Existing Dwelling Wall
Cross Section (not to scale)

DRAWN BY: E.P.

DATE: 14/02/23

CP-3
SHEET

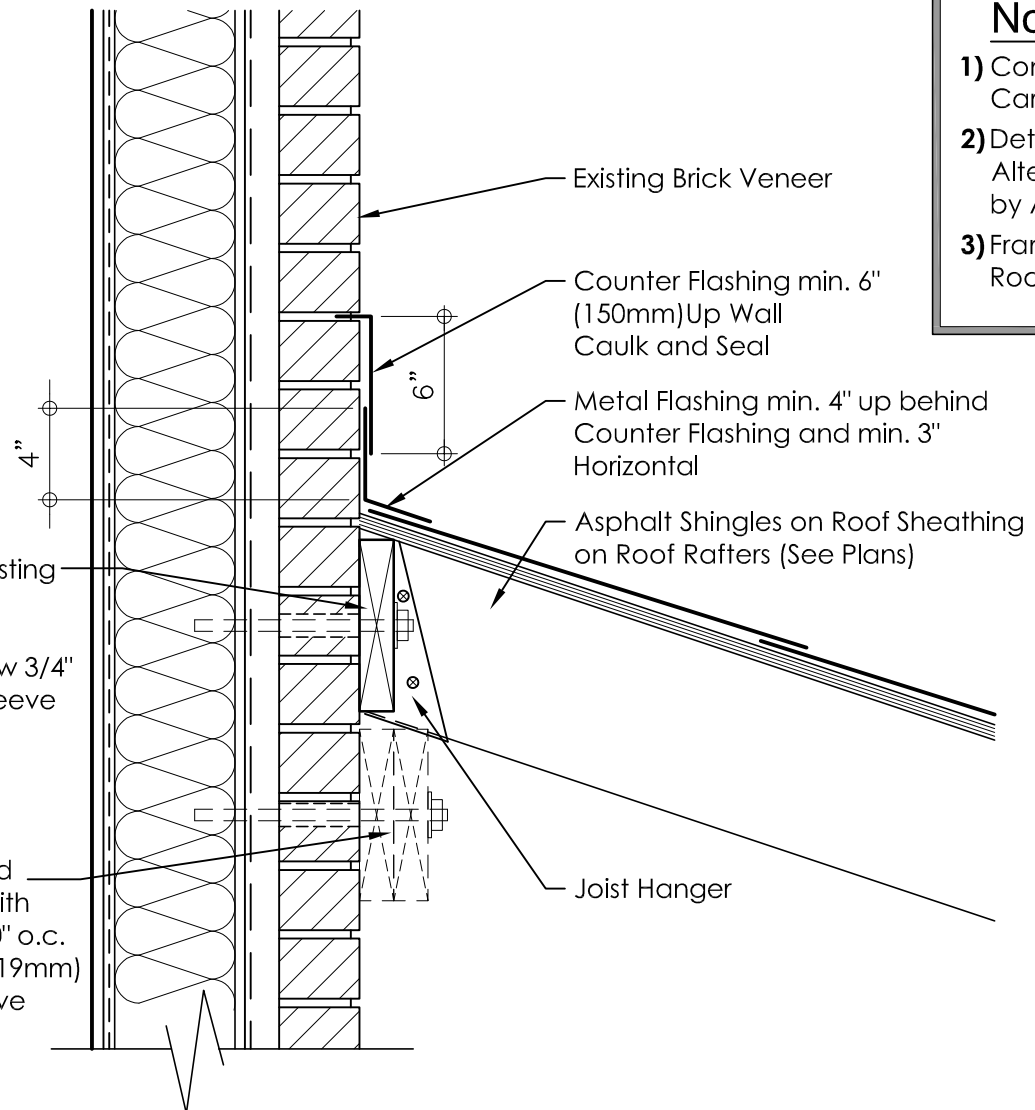

Ledger Secured to Existing Wall Studs with 1/2" Ø Lag bolts @ 32" (812mm) o.c. max. c/w 3/4" (19) Ø Metal Pipe Sleeve Through Brick Veneer

Alternative
2 - 2 x 6 Plates Secured to Existing Wall Stud with 1/2" Ø Lag bolts @ 4'-0" o.c. (1.2m)max. c/w 3/4" (19mm) Ø Metal Pipe Sleeve Through Brick Veneer

Notes:

- 1) Connection Details Apply to Carports Only
- 2) Details provided as an Example. Alternative Details to be provided by Applicant.
- 3) Framing Inspection required once Roof Sheathing has been Installed

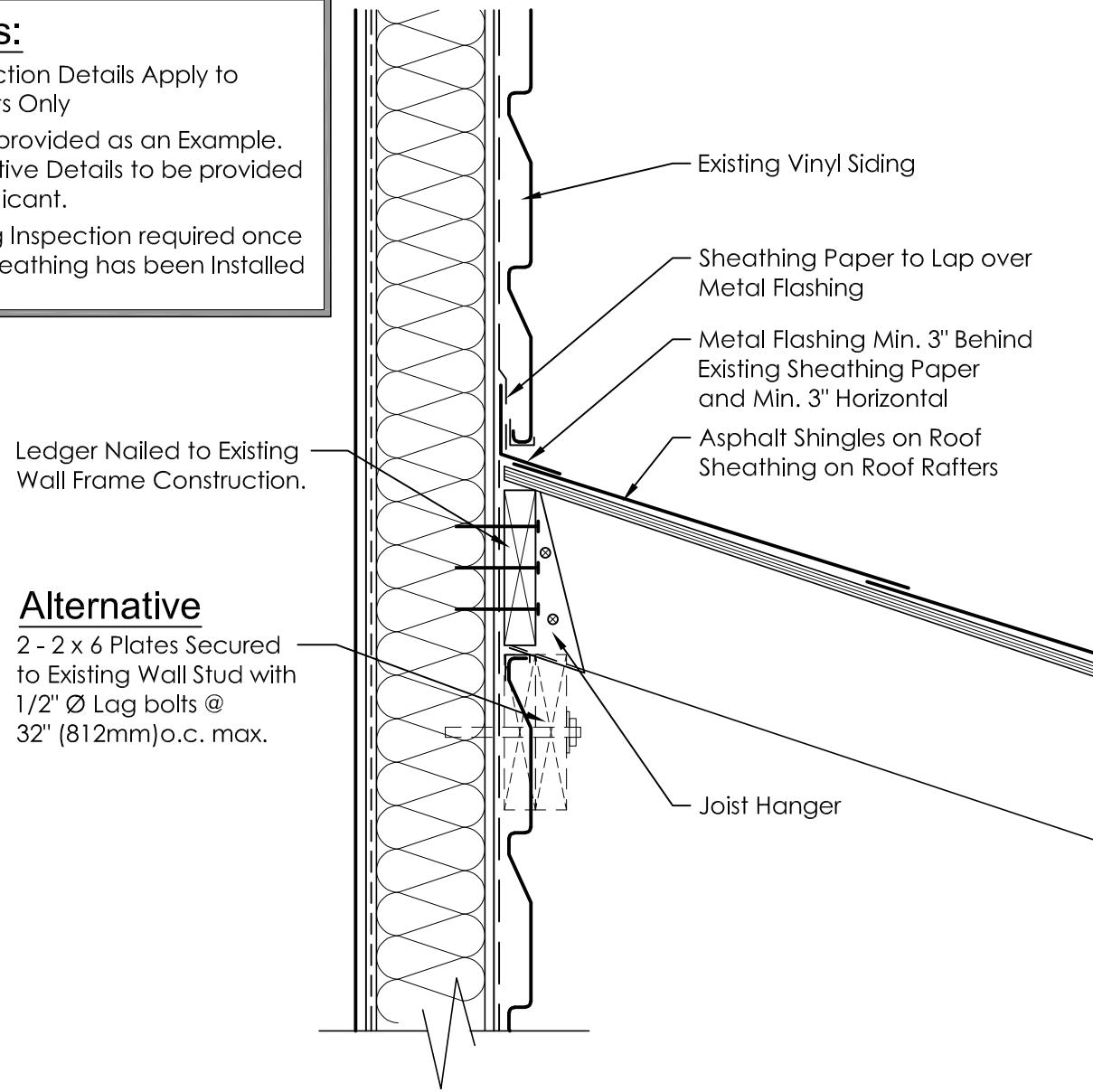

Alternative
2 - 2 x 6 Plates Secured to Existing Wall Stud with 1/2" Ø Lag bolts @ 32" (812mm)o.c. max.

Connection Detail at Brick Veneer Wall

Connection Detail at Vinyl Siding Wall

NOTE:
It is the Contractor's responsibility to ensure that all construction conforms to the requirements of the Ontario Building Code. Notations made on these drawings are for your information and assistance only and do not necessarily comment on all areas of construction.



Attached Carport
Attached to Existing Dwelling Wall
Sloping Roof Details (not to scale)

DRAWN BY: E.P.
DATE: 14/02/23
CP-4
SHEET